

INSTRUCTIONS

You can use common wood glue. It's easier to colour the parts before mounting. Only for decoration, no toy! Suitable for children older than 5 years. Children under 5 years only under supervision of an adult.

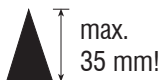

Attention!

- don't let children or pets alone with the incense
- not suitable for children's hand
- always use incense, don't use candles

10107 Smoking mushroom

You can find our complete range of do-it-yourself-kits on

www.hobaku.de

Drechserei Kuhnert GmbH

08237 Steinberg

Hauptstr. 28

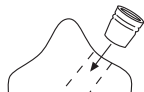
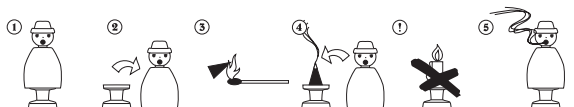

1.) Glue the chimney, the hat of the mushroom and the door together to create the mushroom.

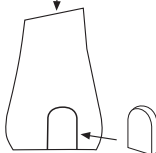

2.) Colour the mushroom.

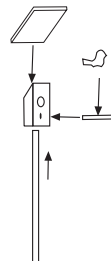

3.) Stick together the bird's house and put the small bird on the rod.

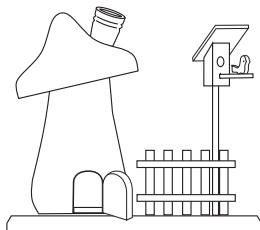
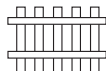

4.) Glue the pieces of the fence symmetrically.

5.) The bird's house and the fence have to be glued on the ground plate. Don't glue the mushroom on the plate - only put it on the plate of iron.

6.) Now you can decorate the groundplate with stones and moss.