

- Attention!**
- don't let children or pets alone with the burning candle
  - don't let the candle burn on it's own
  - don't use the candle near curtains or heat sources
  - don't clear the candle with water
  - don't put the candle near a wind breeze

## 10120 Lantern frog & co.

You can find our complete range of do-it-yourself-kits on

[www.holzkunst-kuhnert.de](http://www.holzkunst-kuhnert.de)

Drechserei Kuhnert GmbH

08237 Steinberg

Hauptstr. 28



## INSTRUCTIONS

You can use common wood glue. It's easier to colour the parts before mounting. Only for decoration, no toy! Suitable for children older than 5 years. Children under 5 years only under supervision of an adult.

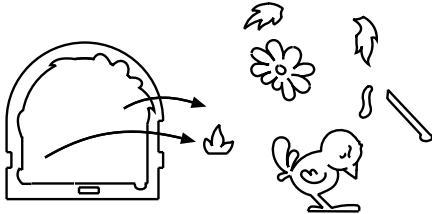

- 1.) Put a cut resistant plate underneath the sheet of plywood then working with the cutter knife. Stick through the small paths of the sheet of plywood with the help of the cutter knife from both sides. Break out all parts, sand breaking points if needed and colour all parts with the colour you like.

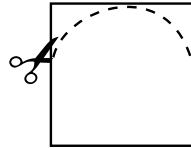

- 2.) Cut the paper so that you can glue it in the back of the lantern sides.

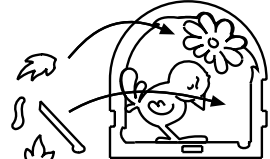

- 3.) Glue all parts into the frame and stick the paper on the back.

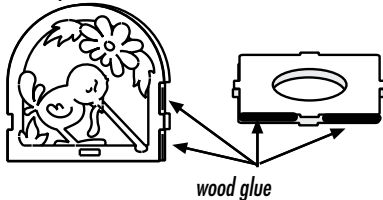

wood glue

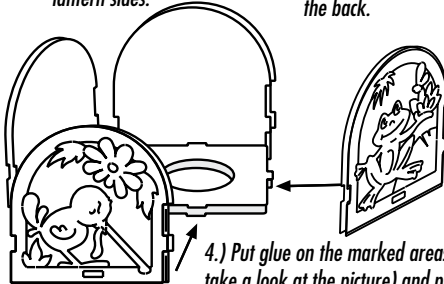

- 4.) Put glue on the marked areas (please take a look at the picture) and put all 4 parts and the ground plate together.