

INSTRUCTIONS

You can use common wood glue. All parts are cutted precisely that's why they have to be glued exactly.

This star can be lighted. Please use our lighting set (number 10113) if you want.



10123 Window star

You can find our complete range of do-it-yourself-kits on

www.hobaku.de

Drechserei Kuhnert GmbH

08237 Steinberg

Hauptstr. 28

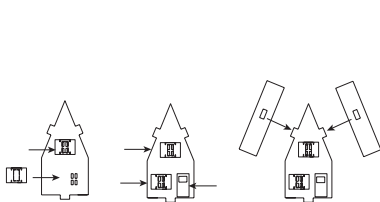

1.) Glue the shutters on the back of the house, please also glue the remaining shutters and the door on the front side of the house.

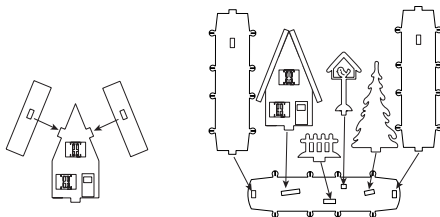

2.) Both roof parts have to be placed.

3.) Stick the house, the fence, the bird's house, both side parts and the tree into the slots of the ground plate.

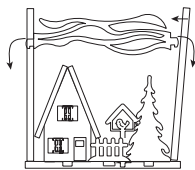

4.) Insert the clouds into both side parts.

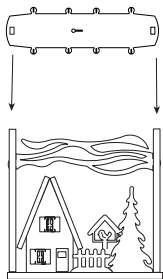

5.) Stick the upper plate on both side parts and decorate it with the moon, stars and birds.

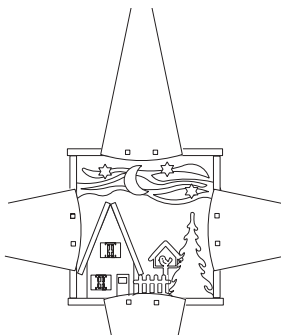
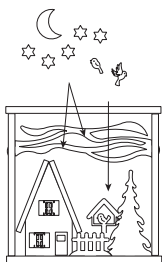

6.) There are 8 big pikes of the star which have to be sticked into the middle of all 4 side parts like shown. So stick 4 big pikes to the front and 4 big pikes on the back of the star.

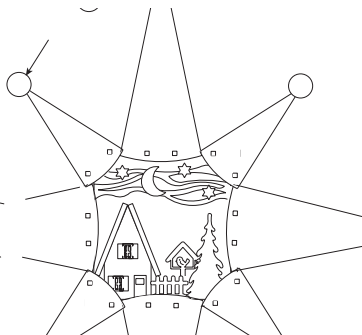

7.) Get all 8 small pikes. Clip on 4 small pikes to the front and the same amount on the back. Now add all balls to the pikes. The pikes are held together by the balls.