

INSTRUCTIONS

You can use common wood glue. It's easier to colour the parts before mounting. Only for decoration, no toy! Suitable for children older than 5 years. Children under 5 years only under supervision of an adult.

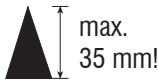

Attention!

- don't let children or pets alone with the incense
- not suitable for children's hand
- always use incense, don't use candles

10126 Smoking oven

You can find our complete range of do-it-yourself-kits on

www.hobaku.de

Drechserei Kuhnert GmbH

08237 Steinberg

Hauptstr. 28

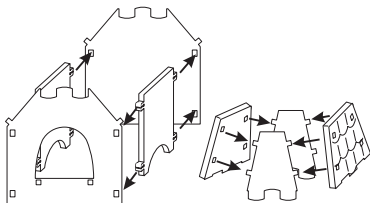
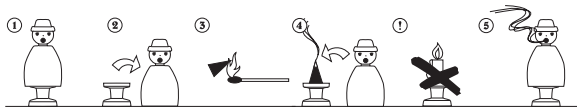

1.) Click together the side parts and front parts of the smoking oven. Please do the same with the chimney of the smoking oven.

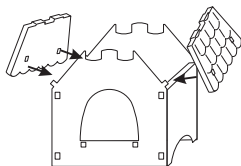

2.) Now glue all parts of the roof, chimney and oven together.

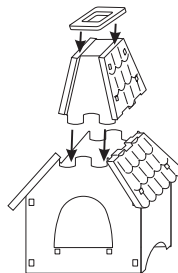

3.) The upper part of the roof, chimney and oven need to be glued together.

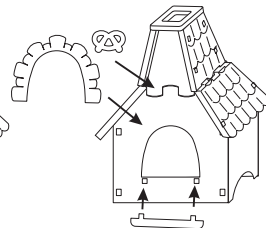

4.) Decorate the oven.

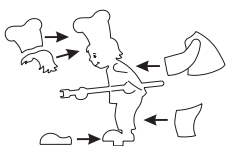

5.) Glue the cap, jacket, pants and shoes on the baker.



6.) Turn the baker and glue his angled arm on his body. Decorate the Brezel on the plate for the bread and glue it into the baker's hand.

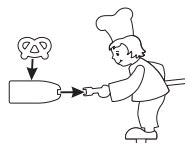

7.) Turn the base plate. Then get the 3 small plates and glue them on the bottom of the plate. The smoking oven will stand on these 3 plates. Glue the small ground plate of the oven on the big ground plate - please notice the correct place for this plate is marked. Insert the iron plate. Glue the sack of flour and the baker on the ground plate.

