



10132 Tea light holder snowman

You can find our complete range of do-it-yourself-kits on

www.hobaku.de

Drechserei Kuhnert GmbH

08237 Steinberg

Hauptstr. 28

Attention!

- don't let children or pets alone with the burning candle
- don't let the candle burn on it's own
- don't use the candle near curtains or heat sources
- don't clear the candle with water
- don't put the candle near a wind breeze

INSTRUCTIONS

You can use common wood glue. It's easier to colour the parts before mounting. Only for decoration, no toy! Suitable for children older than 5 years. Children under 5 years only under supervision of an adult.

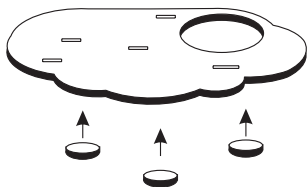

1.) Turn the base plate. Then get the 3 small plates and glue them on the bottom of the plate. The tealightholder will stand on these 3 plates.

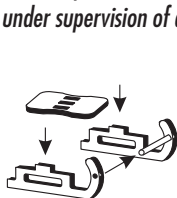

2.) Sledge: First put the round bar into both side parts. After this lay the seat up on the side parts and tie the thread on the round bar. Now you can glue the squirrel on the sledge.

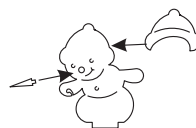
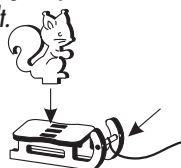

3.) Child of the snowman: glue the hat and the nose on the child's head.

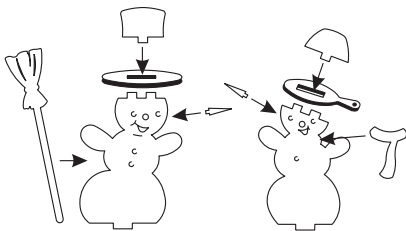

4.) Snowman: glue the hat, nose and broom on the snowman.

5.) Snow woman: glue the pan, nose and scarf.

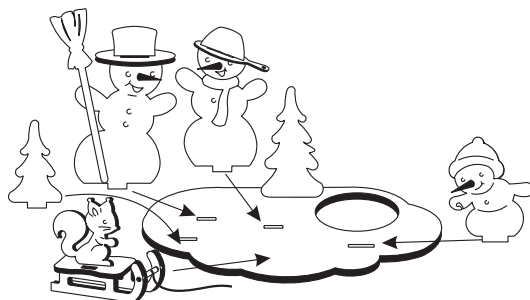

6.) Tie the thread of the sledge into the hand of snowman's child. Now please glue all things on the plate: trees, snowman, snow woman, child of snowman and the sledge. Then you can put in the glass for the tea light.