

# INSTRUCTIONS

You can use common wood glue. All parts are cutted precisely that's why they have to be glued exactly. It's easier to colour the parts before mounting. Only for decoration, no toy! Suitable for children older than 5 years. Children under 5 years only under supervision of an adult.

- 1.) Put a cut resistant plate underneath the sheet of plywood when working with the cutter knife. Stick through the small paths of the sheet of plywood with the help of a cutter knife from both sides.
- 2.) Break out all parts, sand breaking points if needed and colour all parts with the colour you like.

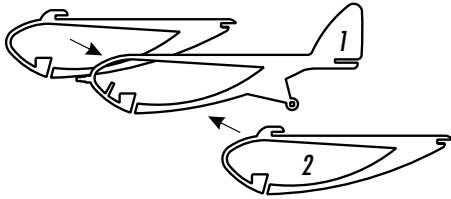

- 3.) Take parts 2 (left and right side) and glue them on part 1.

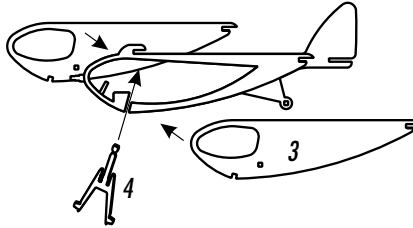

- 4.) Both parts 3 have to be glued exactly. Please put glue on the slots of part 4 and place them like shown.

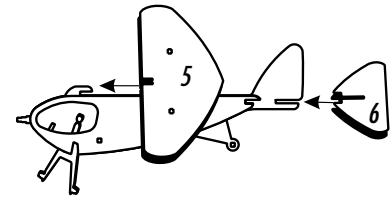

- 5.) Place glue on the slots of part 5 and part 6. Then you can fix them.

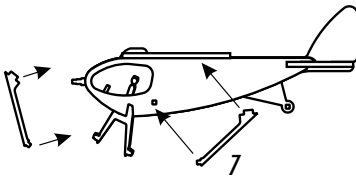

- 6.) Now please stick with glue parts 7 on the left and right side.

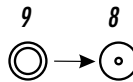

- 7.) After this wheels 9 can be glued on the big wheels 8.

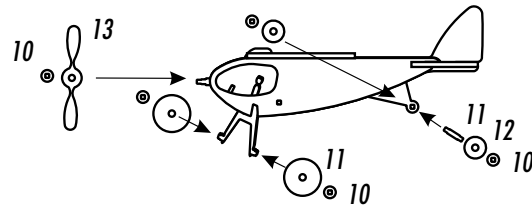

- 8.) Please glue all parts like shown on the picture.

## 10135 Sports plane

You can find our complete range of do-it-yourself-kits on [www.holzkunst-kuhnert.de](http://www.holzkunst-kuhnert.de)  
Drechserei Kuhnert GmbH  
08237 Steinberg  
Hauptstr. 28