

# INSTRUCTIONS

You can use common wood glue. It's easier to colour the parts before mounting. Only for decoration, no toy! Suitable for children older than 5 years. Children under 5 years only under supervision of an adult.

1.) Put a cut resistant plate underneath the sheet of plywood when working with the cutter knife. Stick through the small paths of the sheet of plywood with the help of the cutter knife from both sides.

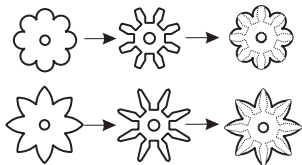

3.) Stick together both flowers like shown.

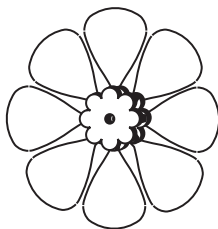

The material of the wings is made of coated furni-lux to make the windmill more stable. This material can not be coloured!

## 10140/10141 Windmills

You can find our complete range of do-it-yourself-kits on

[www.hobaku.de](http://www.hobaku.de)

Drechserei Kuhnert GmbH

08237 Steinberg

Hauptstr. 28

2.) Break out all parts.

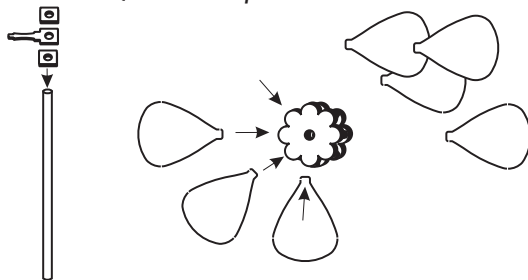

4.) Put the square piece on the round bar and glue the wooden piece (axle on top) on the square piece. Then put on the second square piece.

5.) Glue the wings of the windmill diagonal into the slots of the flower's head.

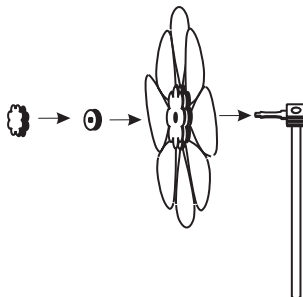

6.) Push the wheel of the windmill on the axle and glue this small plate in front of the axle. Please also glue the small flower on the small plate.